

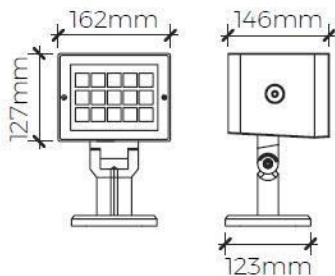

## NURU-FL440044

### 40W FLOOD LIGHT



### PRODUCT SPECIFICATIONS

Fixture Material	Die-cast Aluminium
Fixture Finish	Powder-coated Gray
Glass	High intensity Tempered Glass
Optic	Acrylic Optical lens
Driver	Built-in
Binning:	3 Step MacAdam
Wiring	90 Centimeter of 3 core 0.75mm <sup>2</sup> rubber cable
Life Span	50,000 hours

LED Chip	CREE
Power Consumption	40W
Input Voltage	180~250V AC, 50/60Hz
Operating Temperature	from -20° to 65° C
Color Rendering Index	>85
Driver Protection	Short Circuit
Warranty	3 years against manufacturing defects
Agency Approval	CE, RoHS



Power (W)	Available color Temperatures	Luminous Flux			IP Rating	Available Beam Angles
		3000K	4000K	6000K		
40W	2700K 3000K 4000K 6000K RGB	110lm/W	120lm/W	130lm/W	66	6° 12° 30° 48°

**Standard option.**

Non-standard products may be subject to MOQ. Contact your regional sales representative for more information.



## INSTALLATION GUIDE

Find the location where the flood light has to be installed. Install suitable wiring from the main supply (220-240V AC, 50/60Hz) to the light fixture.

- **Step 1:** Fix the bracket on a hard surface using Stainless steel screws and fisher.
- **Step 2:** Attach a junction box near by the fixture and make all the connections inside the junction box.
- **Step 3:** Connect the fixture power cable to the main supply using terminal blocks or connectors. Please make sure the earth (ground) wire is reliable.
- **Step 4:** Wrap connectors or terminal blocks with electrical tape.
- **Step 5:** Adjust the fixture bracket to the correct angle and tighten the screws.



Step 1

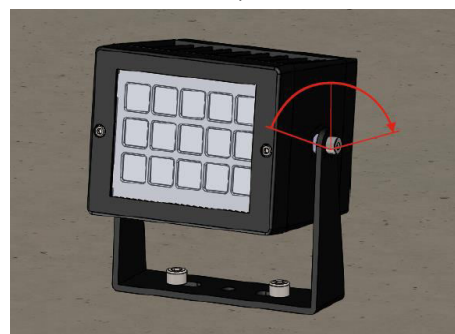

Step 5



Please kindly read the instructions carefully before installation, and keep it well for your future reference.

**All the Installation and Maintenance must be done by Technicians and Professional Engineers**