

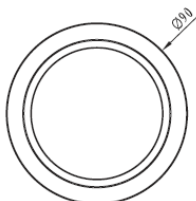

SANA-DL110401

15W SURFACE MOUNTED DOWN LIGHT

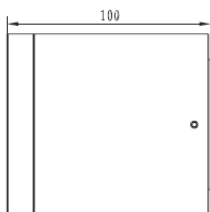

PRODUCT SPECIFICATIONS

Fixture Material	Die-cast aluminum
Fixture Finish	Powder-coated white. Also available in black
Reflector	Polycarbonate with aluminum coating
Driver	Built-in
Dimmability	Non-Dimmable. Also available Standard Phase Dimming.
Binning	3 Step MacAdam
Life Span	40,000 hours

LED Chip	CREE COB
Power Consumption	15W
Input Voltage	180~250VAC, 50/60Hz
Operating Temperature	from -20° to 50° C
Color Rendering Index	>80
Warranty	5 years against manufacturing defects
Agency Approval	CE, RoHS



Power (W)	Available color Temperatures	LED Chip Lumen Efficacy			Power Factor	Available Beam Angles
		3000K	4000K	6000K		
15W	2700K 3000K 4000K 6000K	80lm/W	85lm/W	90lm/W	> 0.8	60°

Standard option.

Non-standard products may be subject to MOQ. Contact your regional sales representative for more information.